

# EN 1092-1 TYPE 01B PN10

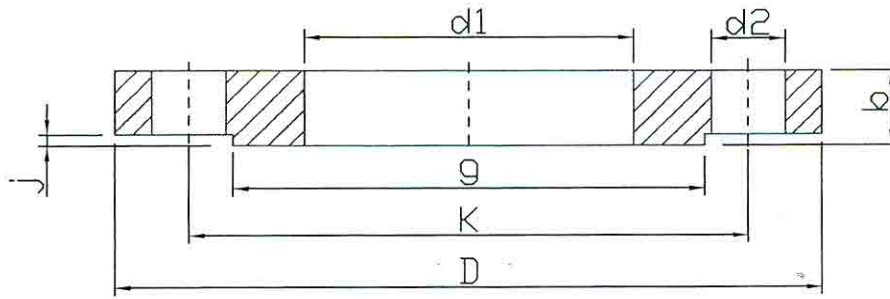

DN	pipe	d1	k	D	j	b	g	d2	Thread	Number of drills	Weight kg
200	219,1	221,5	295	340	3	24	268	22	M20	8	<b>8,532</b>
250	273,0	276,5	350	395	3	26	320	22	M20	12	<b>10,936</b>
300	323,9	327,5	400	445	4	26	370	22	M20	12	<b>12,252</b>
<b>DN15-DN150: DIMENSIONS IDENTICAL WITH PN16</b>											